

\$529,000 - 634 Glenwright Crescent, Edmonton

MLS® #E4429793

\$529,000

4 Bedroom, 3.50 Bathroom, 1,793 sqft

Single Family on 0.00 Acres

Glastonbury, Edmonton, AB

New paint 2 storey home located in Glastonbury. Back on the Park. Some features are the speakers in the ceiling and the smart wiring. You will find crown molding in the living room, master bedroom and half bath on the main floor. Open concept with 9' ceilings in the bonus room. There are hardwood floors in the kitchen, entry way and nook. French doors lead to the basement. The kitchen has tiled backsplash. Enjoy the main floor fireplace with tile surround and mantle. Outside you will be pleased to find a 12 ft deck and patio with a natural gas line.

Built in 1999

Essential Information

| | |
|----------------|------------------------|
| MLS® # | E4429793 |
| Price | \$529,000 |
| Bedrooms | 4 |
| Bathrooms | 3.50 |
| Full Baths | 3 |
| Half Baths | 1 |
| Square Footage | 1,793 |
| Acres | 0.00 |
| Year Built | 1999 |
| Type | Single Family |
| Sub-Type | Detached Single Family |
| Style | 2 Storey |

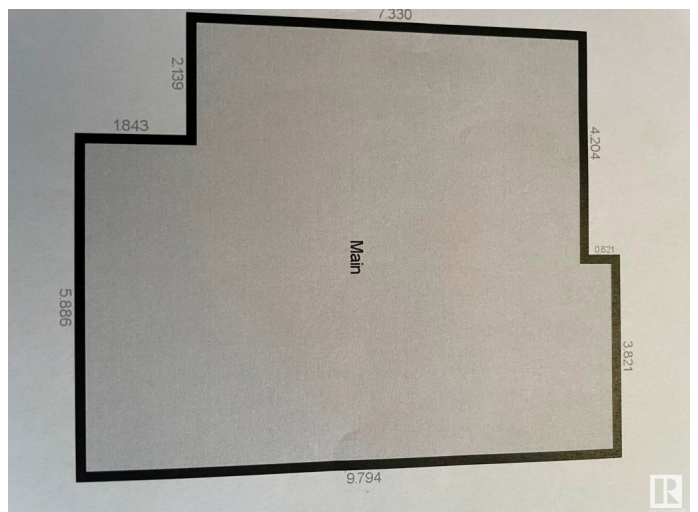

| | |
|--------|--------|
| Status | Active |
|--------|--------|

Community Information

| | |
|-------------|-------------------------|
| Address | 634 Glenwright Crescent |
| Area | Edmonton |
| Subdivision | Glastonbury |
| City | Edmonton |
| County | ALBERTA |
| Province | AB |
| Postal Code | T5T 6K7 |

Amenities

| | |
|-----------|------------------------|
| Amenities | Deck |
| Parking | Double Garage Attached |

Interior

| | |
|-------------------|-----------------------------------------------------------------------------------------------------------------------------|
| Interior Features | ensuite bathroom |
| Appliances | Dishwasher-Built-In, Dryer, Garage Control, Garage Opener, Hood Fan, Refrigerator, Stove-Electric, Washer, Window Coverings |
| Heating | Forced Air-1, Natural Gas |
| Fireplace | Yes |
| Fireplaces | Glass Door, Mantel |
| Stories | 3 |
| Has Basement | Yes |
| Basement | Full, Finished |

Exterior

| | |
|-------------------|---------------------------------------------------------------------------|
| Exterior | Wood, Vinyl |
| Exterior Features | Backs Onto Park/Trees, Fenced, Landscaped, Public Transportation, Schools |
| Roof | Asphalt Shingles |
| Construction | Wood, Vinyl |
| Foundation | Concrete Perimeter |

Additional Information

| | |
|----------------|-----------------|
| Date Listed | April 9th, 2025 |
| Days on Market | 11 |
| Zoning | Zone 58 |
| HOA Fees | 170 |

HOA Fees Freq. Annually

DATA IS DEEMED RELIABLE BUT IS NOT GUARANTEED ACCURATE BY THE REALTORS® ASSOCIATION OF EDMONTON. COPYRIGHT 2025 BY THE REALTORS® ASSOCIATION OF EDMONTON. ALL RIGHTS RESERVED.Trademarks are owned or controlled by the Canadian Real Estate Association (CREA) and identify real estate professionals who are members of CREA (REALTOR®, REALTORS®) and/or the quality of services they provide (MLS®, Multiple Listing Service®)

Listing information last updated on April 20th, 2025 at 6:17am MDT